

CATALOG

product range



www.storm-company.com



ברלין טכנולוגיות בע"מ
שדרות גן רווה 13, יבנה, 8122214
<http://www.berlintech.co.il/>
mail@berlintech.co.il
טלפון: 073-7597171
פקס: 08-6638120

Presentation

"STORM S" S.A. was established in 1990 in Gabrovo, Bulgaria and has manufactured machines and equipment for food processing industry for more than 20 years. The enterprise has two production bases – in Gabrovo and Plovdiv, Bulgaria. The main headquarter of the company is in Plovdiv.

"STORM S" S.A. offers full range of services, technologies, machines and equipment for food processing industry - consulting, technological projects, modernization, introducing of new technologies.

Thanks to its 20-year history, our company is able to offer complete decisions based on experience, contemporary technologies and tempting financial terms.

Engineering and design work of the company aims to develop high-technological machines with low energy consumption based on its own patents, thereby providing high quality world-class self-engineering production.



Two patents of the company were awarded with medals in 2001 in Pittsburgh, USA at the 17th World Salon of INPEX Innovations:

- gold medal:

for automatic cutting of carcasses into halves with no waste for the needs of conveyor systems in slaughterhouses;

- silver medal:

for energy saving method and equipment for pressing raw materials into briquettes.

The same year, at "Euro Intellect" exhibition in Sofia, Bulgaria these patents were awarded again. The two gold medals proved again the world level of the company.

On March 1st 2010 in Paris, France our company was awarded with GOLDEN EUROPEAN AWARD FOR QUALITY 2010 in recognition for business success and quality of production.

The company complies with ISO 9001:2008, , GOST.



STORM S S.A. company has two modern equipped production bases. In the recent years the company has made large investments to modernize its machinery park.



WATERJET CNC 3D

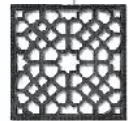

BENDING CNC 3D PRESSBRAKE

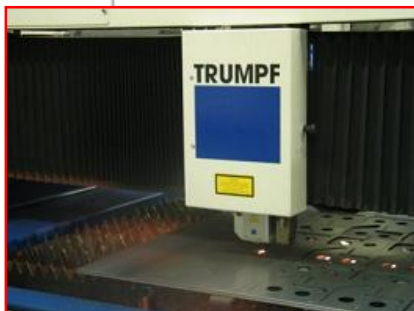

GUILLOTINE CUTTING

LASER CUTTING

PRECISE ARGON WELDING



LATHE CNC 4 AND 5-AXES
VERTICAL CENTRES

CONTENT

6

COLUMN LIFTERS

9

COLUMN LIFTER WITH MOVABLE CHUTE
31.1540.22

18

SWING LOADERS



The STORM S S.A. company informs that individual differences may appear between the machines shown in this catalogue and those offered for sale due to either design changes or the individual orders of our customers.

LIFTING EQUIPMENT

Our company produces a wide range of lifting and turning equipment. In accordance with the working principles they are divided into column lifters and swing loaders. Both of them can be mobile or fixed.

Swing loaders are appropriate for loading of heavy loads; the lifting height is limited.

Column lifters are appropriate for lifting to a higher altitude. For really high altitudes and heavy loads we offer two-column lifters.

Our company is entirely Customer oriented. We offer standard and optional equipment depending on our customers' needs and requirements.

Our lifting equipment is designed following the latest technologies and in accordance with all safety rules.

Machines comply with the Council Directives No. 2006/42/EC and 2006/95/EC and USDA regulations.

ISO 9001:2008



Machines comply with standards HACCP, EN 1672-2, the Council Directives No. 2006/42/EC and 2006/95/EC and USDA regulations.



COLUMN LIFTERS

31.0325.00 and 31.5325.00

These devices are designated for easy and comfortably lifting and turning of 200 l trolleys. They consist of a column, motor with brake with leading system of double chain and fork (straight or 90 °).

The security system is standard (two chains).

They can be fixed or movable (only for max. turning height 2550 mm). Execution-left or right.

If the turning height is over 3050 mm is required additional fixation to the wall or ceiling

The machines complies with the Council Directives No. 2006/42/EC and 2006/95/EC and USDA regulations.

They are made entirely of stainless steel, 1.4301 DIN (AISI 304), excluding runner, chains and their wheels.



in front

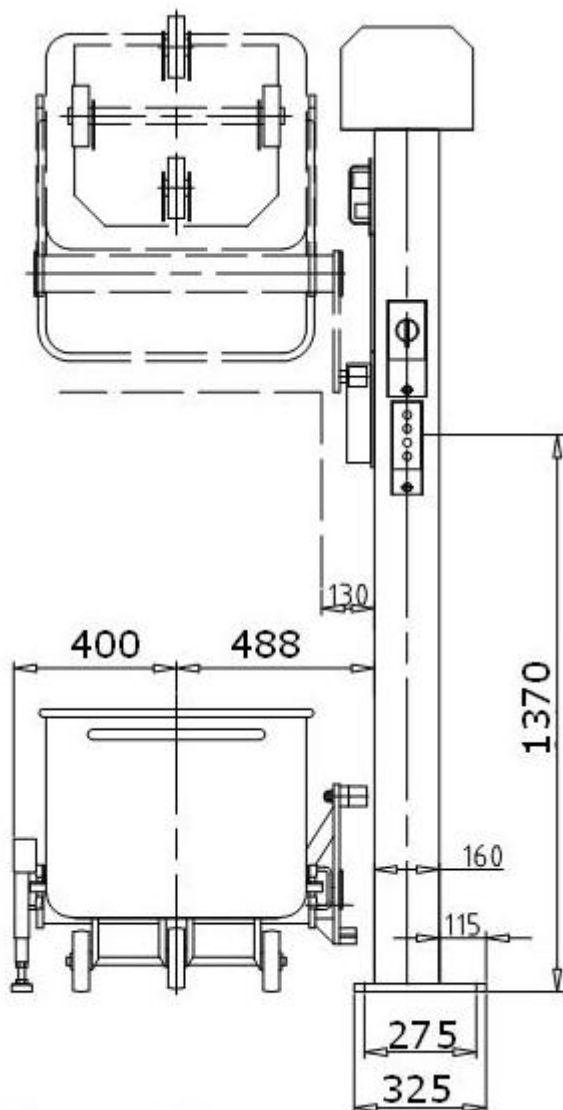

sidewards

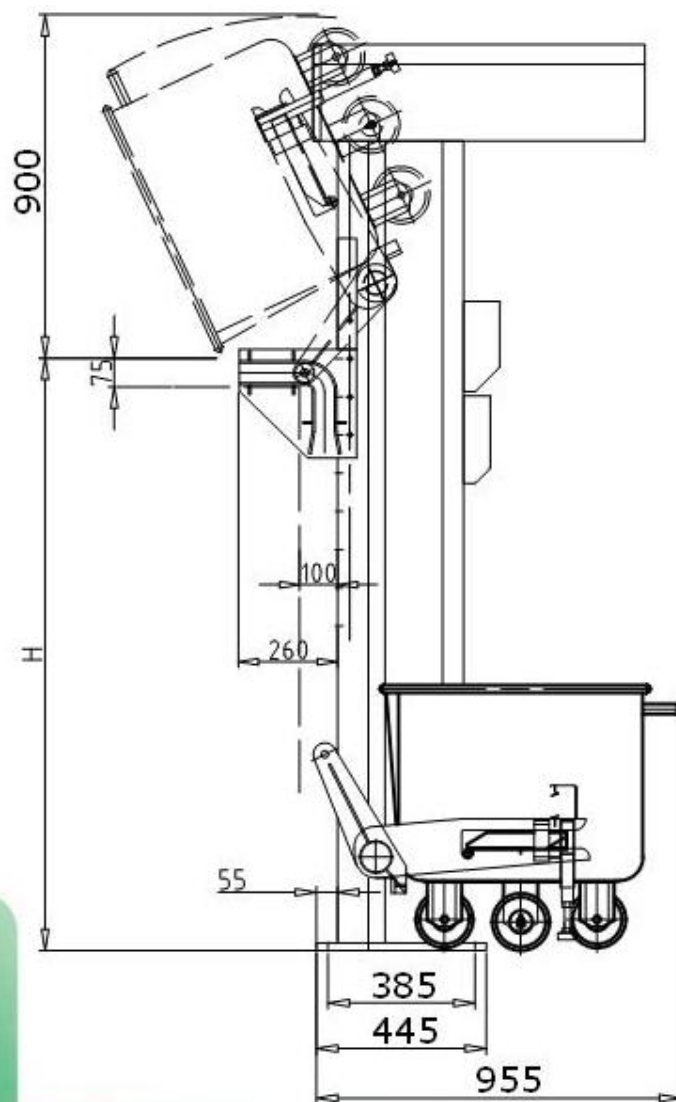

above

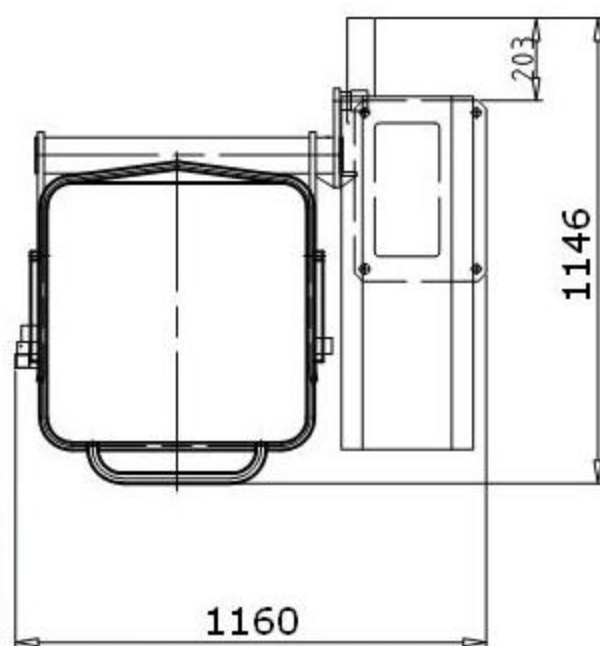



COLUMN LIFTER WITH MOVABLE CHUTE

31.1540.22

The device is designated for easy and safety lifting and turning of 300 l trolleys.

Standard stable execution with second fixing to the ceiling (or column of the construction of the building).

It consists of a column, motor with leading system of two chains, straight fork, special movable chute and safety fence.

The security system is standard. Execution-right.

Lifting principle – two roller chains.

It is made entirely of stainless steel, 1.4301 DIN (AISI 304) grade with permission for contact with food - according to the standard.

There is a movable chute with a special form to provide loading of the cooking vessel. The chute is fixed to the column and rotates to get the necessary position for loading automatically.

It is possible to use full automatic regime for loading - the cooking vessel can control the lifting process.

There is a full buggy put on the fork of the lifter. When the vessel's lid opens, the lifting process starts. The chute moves to the correct position and the buggy lifts and tilts. After loading, the buggy takes down and the chute can return to basic position.

Thanks to the electromechanical lock the safety fence is locked during the motion of the buggy. The whole process is secured – the automatic defense system, sound and light signals are standard.



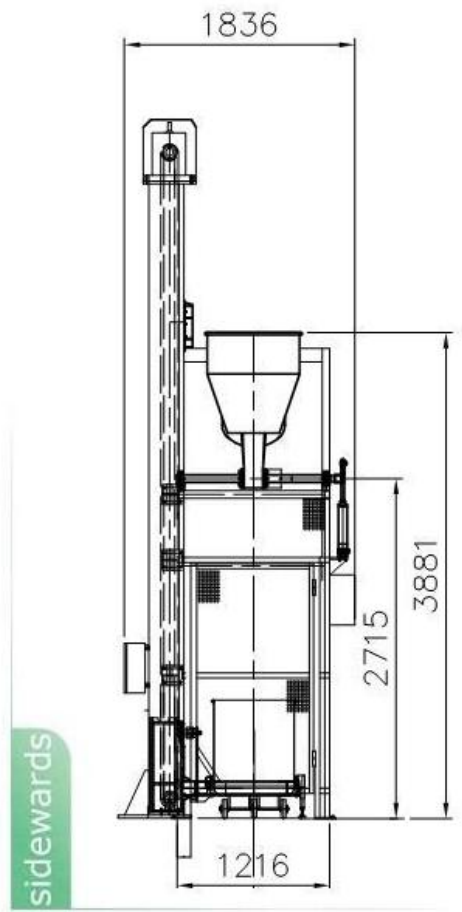
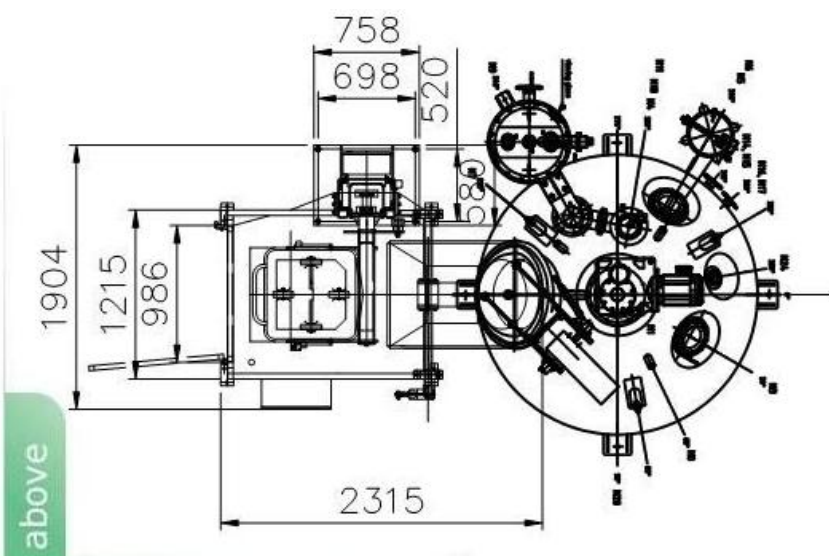
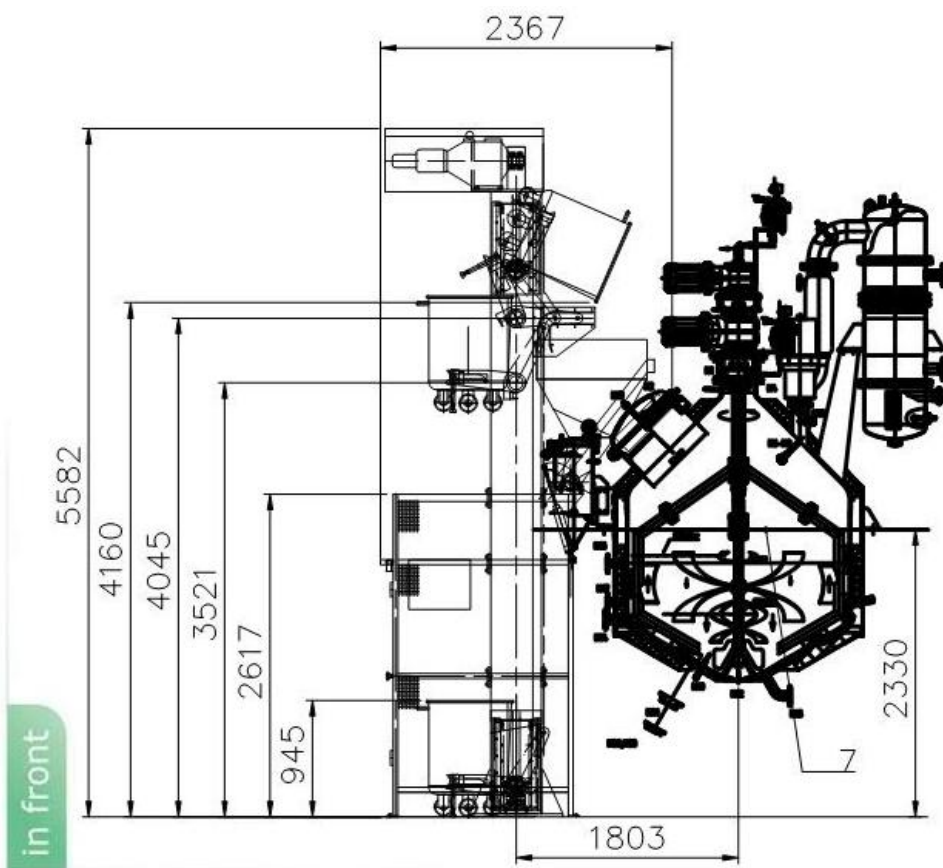

LIFTING EQUIPMENT - COLUMN LIFTERS

Art. No.	31.0315.00	31.0320.00	31.0325.00	31.0330.00
Dimensions (L,W,H mm)	1160/1146/2450	1162/1060/2950	1160/1146/3450	1448/1598/3950
Designation	200 l trolleys	200 l trolleys	200 l trolleys	200 l trolleys
Elevating capacity kg	300	300	300	300
Turning height – mm (can be regulated in 5 stages of 100 mm)	1050-1550 mm	1550-2050 mm	2050-2550 mm	2550-3050 mm
Max. height by turning – mm	2450 mm	2950 mm	3450 mm	3950 mm
Fork type standard/ at 90°	standard	standard	standard	standard
Fixed/mobile	yes/no	yes/no	yes/no	yes/no
Left/right	31.0315.00/31.1315.00	31.0320.00/31.1320.00	31.0325.00/31.1325.00	31.0330.00/31.1330.00
Installed power - kW	0,8	0,8	0,8	0,8
Power supply -electricity	3 400V/50Hz	3 400V/50Hz	3 400V/50Hz	3 400V/50Hz

Art. No.	31.0335.00	31.0340.00	31.0345.00	31.0350.00
Dimensions (L,W,H mm)	1160/1146/4450	1160/1146/4950	1160/1146/5450	1160/1146/5950
Designation	200 l trolleys	200 l trolleys	200 l trolleys	200 l trolleys
Elevating capacity kg	300	300	300	300
Turning height – mm (can be regulated in 5 stages of 100 mm)	3050-3550 mm	3550-4050 mm	4050-4550 mm	4550-5050 mm
Max. height by turning – mm	4450 mm	4950 mm	5450 mm	5 950 mm
Fork type standard/ at 90°	standard	standard	standard	standard
Fixed/mobile	yes/no	yes/no	yes/no	yes/no
Left/right	31.0335.00/31.1335.00	31.0340.00/31.0340.00	31.0345.00/31.0345.00	31.0350.00/31.0350.00
Installed power - kW	0,8	0,8	0,8	0,8
Power supply -electricity	3 400V/50Hz	3 400V/50Hz	3 400V/50Hz	3 400V/50Hz



Column lifter for lifting and turning
200L trolleys
– right execution, movable
– carrying capacity up to 300 kg
31.5322.00



Column lifter for
500 kg containers
for better loading of raw material
- left execution
- fixed
31.0625.26



Column lifter for lifting and turning
 – right execution, fixed
 – turning angle 47°
 - additional button for down motion
 31.1330.47

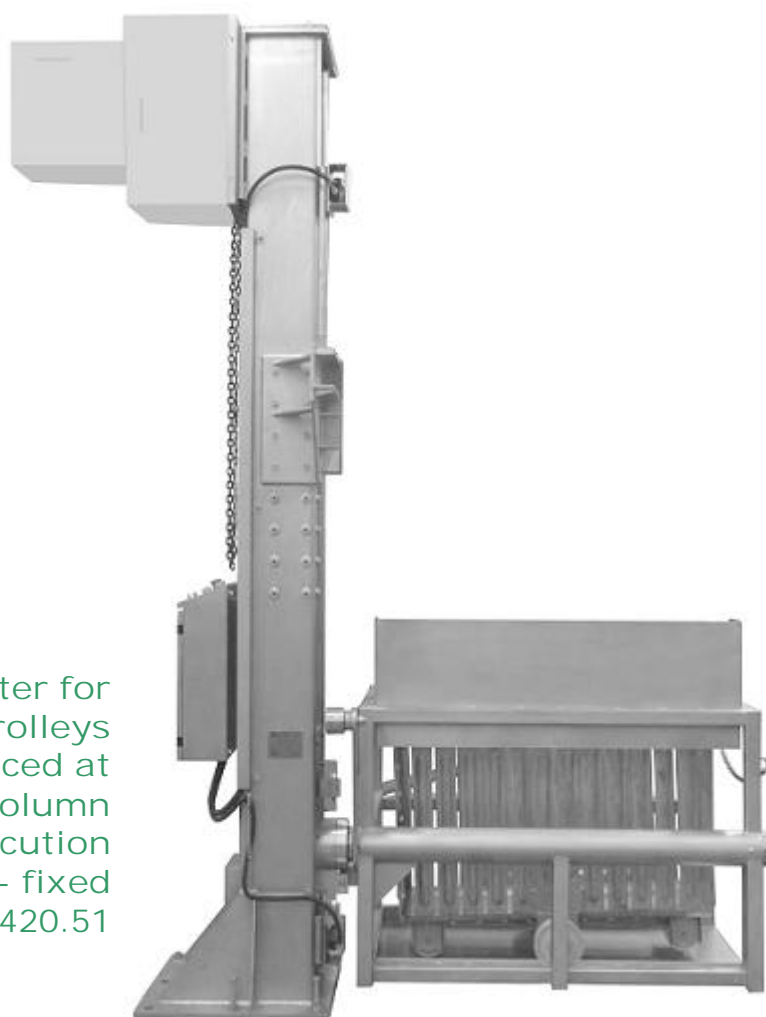

Column lifter for
 special trolleys
 - motor reducer is placed at
 the back side of the column
 - right execution
 - fixed
 31.0420.51

LIFTING EQUIPMENT - COLUMN LIFTERS

Art. No.	31.0625.26	31.0330.47	31.0325.03	31.1540.22
Dimensions (L,W,H mm)	2045/2135/3615	1162/1085/4025	1115/1000/3410	1626/1706/5585
Designation	containers with dimensions 1030 1230 850 mm	200 l trolleys	200 l trolleys	300 l trolleys
Elevating capacity kg	500	300	300	500
Turning height – mm (can be regulated in 5 stages of 100 mm)	2080-2180	2550-3050	2050-2550	4045
Max. height by turning – mm	3735	4025	3410	5585
Fork type standard/ at 90°	standard	standard	standard	standard
Fixed/mobile	yes/no	yes/no	yes/no	yes/no
Left/right	31.0625.26/31.1625.26	31.0330.47/31.1330.47	31.0325.03/31.1325.03	31.0540.22/31.1540.22
Installed power - kW	2,25	0,8	0,8	1,6
Power supply -electricity	3 400+230V/50Hz	3 400+230V/50Hz	3 400+230V/50Hz	3 400+230V/50Hz
Miscellaneous		turning angle 47°; additional button for down motion	stainless steel chain	with movable chute and safety fence

Art. No.	31.0423.52	31.0420.51	31.0350.05	31.0355.05
Dimensions (L,W,H mm)	2136/1330/3925	2520/1330/3135	1162/1060/5950	1162/1060/6450
Designation	special trolleys with dimensions 1180 580 820 mm	special trolleys with dimensions 1180 580 820 mm	300 l trolleys	300 l trolleys
Elevating capacity kg	450	450	300	300
Turning height – mm (can be regulated in 5 stages of 100 mm)	1720-2220	1550-2050	4550-5050	5050-5550
Max. height by turning – mm	3430	3268	6125	6625
Fork type standard/ at 90°	at 90°	at 90°	standard	standard
Fixed/mobile	yes/no	yes/no	yes/no	yes/no
Left/right	31.0423.52/31.1423.52	31.0420.51/31.1420.51	31.0350.05/31.1350.05	31.0355.05/31.1355.05
Installed power - kW	1,5	1,5	0,8	0,8
Power supply -electricity	3 400+230V/50Hz	3 400+230V/50Hz	3 400+230V/50Hz	3 400+230V/50Hz
Miscellaneous	Motor-reducer is at the back side of the column	Motor-reducer is at the back side of the column		



Column lifter
 – left execution, movable
 – with chute for tumbler loading
 31.0317.20

Column lifter
 - for containers
 - with chute
 - left execution
 - fixed
 31.0324.00



Column lifter for containers
with movable chute
for better loading of raw material
- left execution
- fixed
31.0620.25



Column lifter
- max. turning height 700 mm
- left execution
- fixed
31.0307.22

LIFTING EQUIPMENT - COLUMN LIFTERS

Art. No.	31.0317.20	31.0324.00	31.0317.22	31.0620.25	31.0307.22
Dimensions (L,W,H mm)	1398/2034/2905	1162/1146/3490	1110/1060/2660	1869/1380/3532	1162/1060/1725
Designation	200 l trolleys	200 l trolleys	200 l trolleys	containers	200 l trolleys
Elevating capacity kg	300	300	300	600	300
Turning height – mm (can be regulated in 5 stages of 100 mm)	1200-1700	2100-2400	1200-1700	1300-1400	400-700
Max. height by turning – mm	2905	3510	2741	3532	1810
Fork type standard/ at 90°	yes/no	yes/no	yes/no	no/yes	yes/no
Fixed/mobile	no/yes	yes/no	yes/no	yes/no	yes/no
Left/right	31.0317.20/31.1317.20	31.0324.00/31.1324.00	31.0317.22/31.1317.22	31.0620.25/31.1620.25	31.0307.22/31.1307.22
Installed power - kW	0,8	0,8	0,8	2,25	0,8
Power supply -electricity	3 400+230V/50Hz	3 400+230V/50Hz	3 400+230V/50Hz	3 400+230V/50Hz	3 400+230V/50Hz
Miscellaneous	Movable, with chute for tumbler loading	with chute (730 475)	with chute (556 410)	with chute for tumbler	

SWING LOADERS

30.1103.00 and 30.2104.00

Swing loader is designated only for fast and effective lifting and turning of 200 L trolleys. They are made of stainless steel, 1.4301 DIN (AISI 304).

They can be driven by hydraulic or pneumatic system.

They can be fixed or movable. Execution-left or right.

The machines comply with the Council Directives No. 2006/42/EC and 2006/95/EC and USDA regulations.



Swing loader for
lifting and turning of 200L trolleys
- carrying capacity up to 350 kg
- pneumatic drive
30.2104.00

Swing loader for
lifting and turning of 200L trolleys
- carrying capacity up to 300 kg
- hydraulic drive
30.1103.00



in front

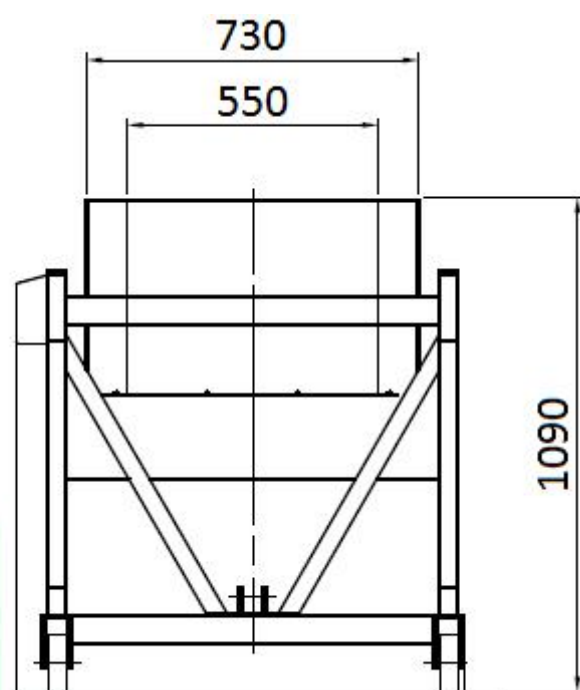

above

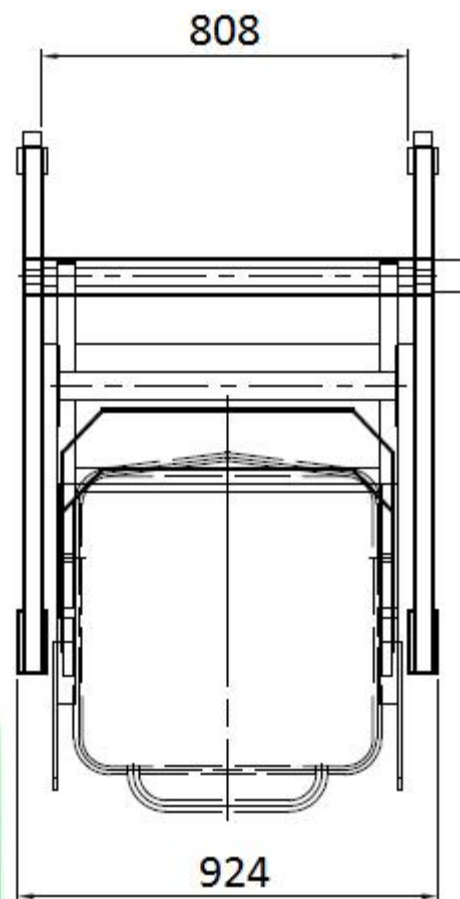

sidewards

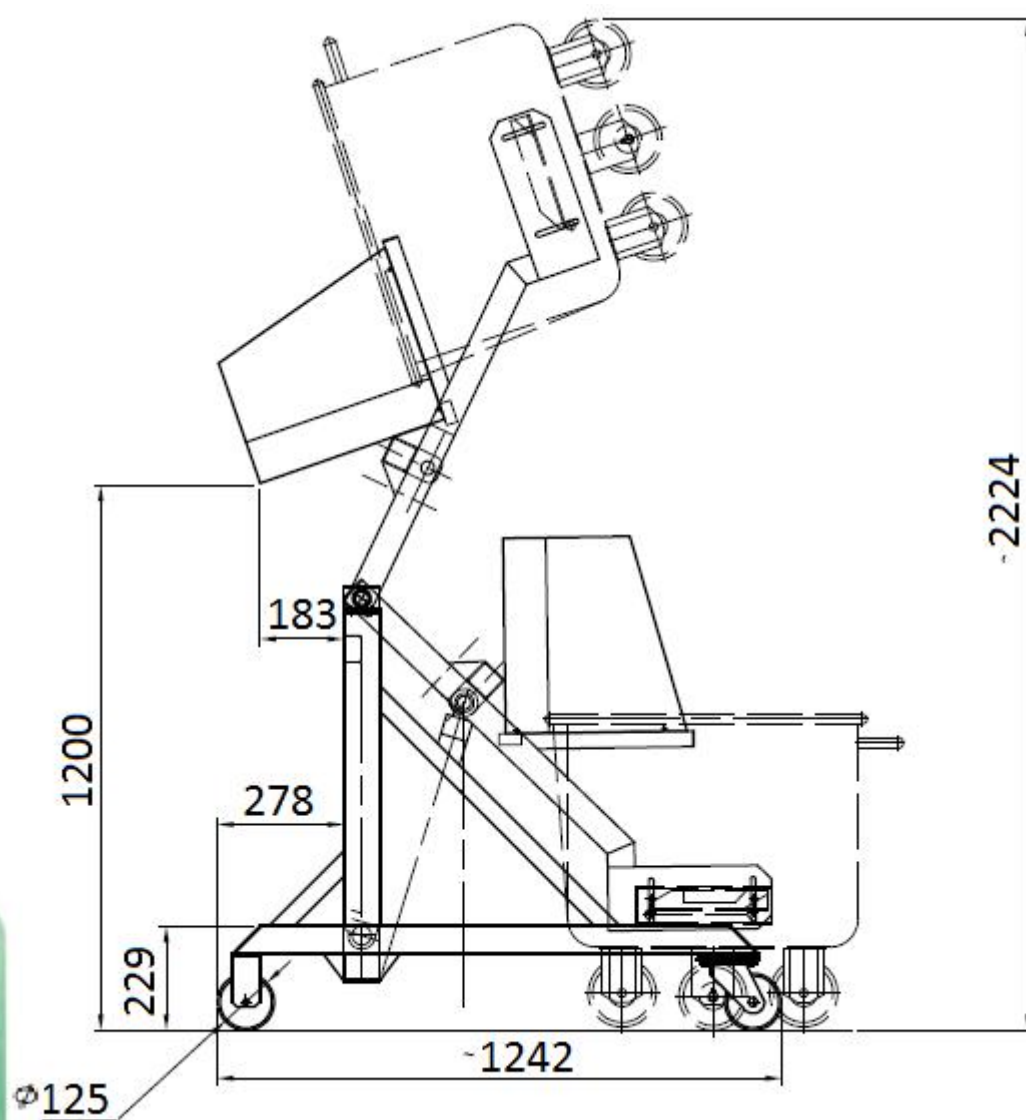

LIFTING EQUIPMENT – SWING LOADERS

Art. No.	30.0003.00	30.1103.00	30.2104.00
Dimensions (L,W,H mm)	1180/900/1080	1220/1117/1200	1242/1100/1090
Designation	200 l trolleys	200 l trolleys	200 l trolleys
Elevating capacity kg	300	300	300
Turning height – mm	1200	1200	1200
Fixed/mobile	yes/no	no/yes	no/yes
Control block - left/right side	30.0003.00/30.1003.00	30.0103.00/30.1103.00	30.3104.00/30.2104.00
Installed power - kW	0,6	0,6	-
Power supply - electricity/water/steam/compressed air/drain	3 400+230V/50Hz	3 400+230V/50Hz	min 0,6 MPa
Miscellaneous	hydraulic	hydraulic	pneumatic



Swing loader for
lifting and turning of
vessels with dimensions
640mm 453,5mm 305mm
- powered by accumulator battery
30.5101.01



Swing loader
for containers
up to 1000 l
30.1009.05



Swing loader
for metal barrels
and plastic drums
30.0103.08



LIFTING EQUIPMENT – SWING LOADERS

Art. No.	30.0103.08	30.5101.01	30.1009.05
Dimensions (L,W,H mm)	1430/990/1270	1160/1160/1240	2055/2050/1300
Designation	barrels (900 mm, ø 600; 970 mm, ø 590) and drums (970 mm, ø 590)	vessels, 640 453,5 305 mm	containers, 1200 1000 760 mm
Elevating capacity kg	300	60	1000
Turning height – mm	990	780	1200
Fixed/mobile	no/yes	no/yes	yes/no
Control block - left/right side	30.0103.08/30.1103.08	no/yes	30.0009.05/30.1009.05
Installed power - kW	0,6	-	2,3
Power supply - electricity/water/steam/ compressed air/drain	3 400+230V/50Hz	-	3 400+230V/50Hz
Miscellaneous	nonstandard fork	with storage battery	



Swing loader for
lifting and turning of 200L buggies
- carrying capacity up to 300 kg
30.1103.00

Belt conveyor
41.1345.03



Wheel carrier
for column lifter
38.5900.00



CONTACTS

BULGARIA

Production base Plovdiv town:

5 „Rogoshko shose“ Str.

tel.: +359 32 511 698

tel.: +359 32 511 645

fax: +359 32 511 689

tel./fax: +359 32 944 774

Production base Gabrovo town:

8 „Aprilovska“ Str.

tel./fax: +359 66 803 556

tel./fax: +359 66 803 009

e - mails: sales@storm-company.com

office_plovdiv@storm-company.com

office_gabrovo@storm-company.com

storm-europe@hotmail.com