

Self-Priming Pumps

B Series

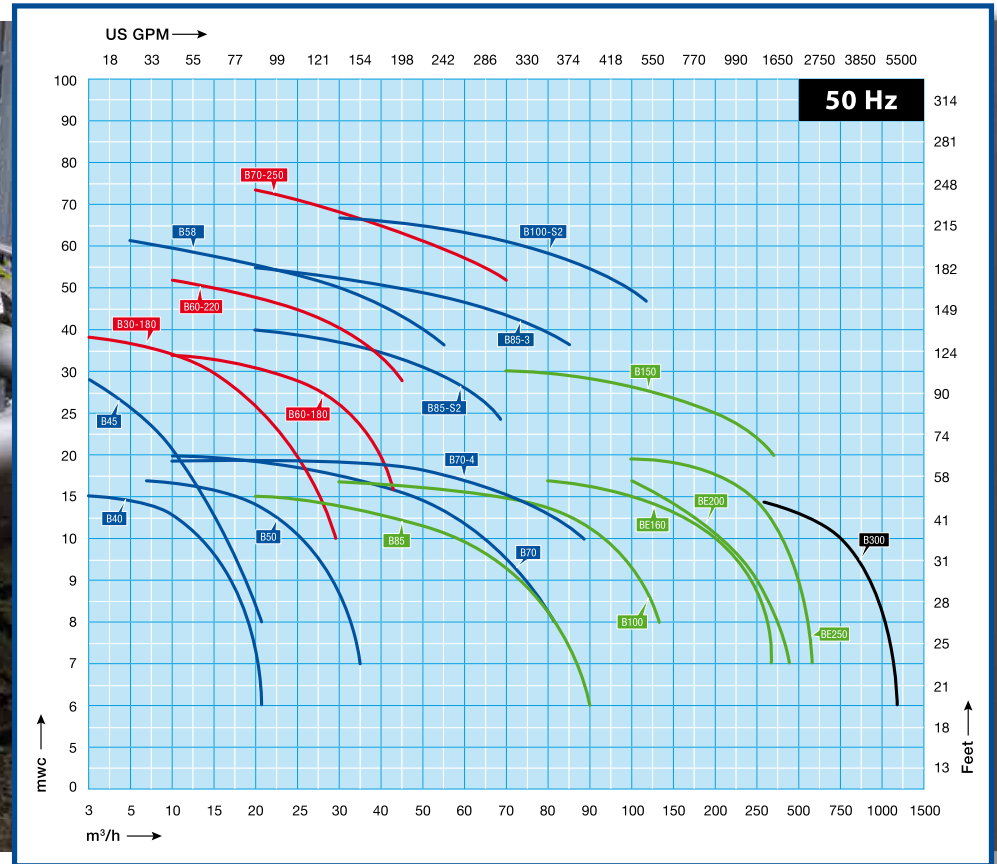

ברלין טכנולוגיות בע"מ
 שדרות גן רוזה 13, יבנה, 8122214
<http://www.berlintech.co.il/>
mail@berlintech.co.il
 טלפון: 08-6638100
 פקס: 08-6638120

Basic and Reliable Technology

The BBA self-priming pumps are ideal for pumping slightly contaminated liquids with or without solid parts. The pumps from the B Series are used in systems where priming can sometimes be difficult and where a regular centrifugal pump doesn't work. Once the pump casing is filled with liquid, pumping air from the suction pipe is extremely simple.

The Heart of the Matter

Semi open impeller

The pumps are constructed with a semi open impeller which is running against a changeable wearplate. Available in cast iron, bronze and stainless steel.

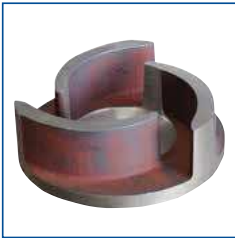

Cutter blade

Several types can be fitted with a stainless steel cutter blade in the impeller for liquids containing fibrous materials.



Stub shaft



Bronze pump casing (BVBMC)

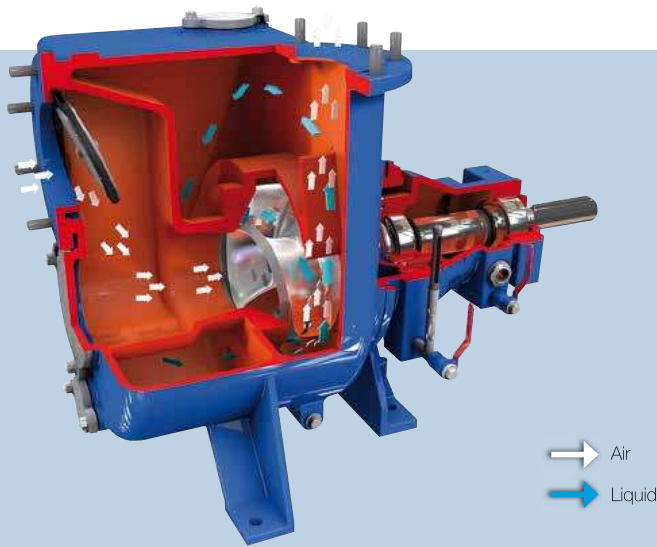

The rotation of the impeller draws the air present in the suction pipe into the pump casing. The air mixes with the liquid present in the pump casing. Liquid and air are transported to the discharge outlet. When all the air has been removed from the suction pipe, the pump draws in liquid.



Stackable frame (+BF)



Wheelbarrow frame (+KF)

Optional Features

Mechanical seals		Extras	
T3W seal	HM / HM / Viton	+F	DIN flanges
MG1 seal	Sic / Sic / EPDM	+FK	DIN flanges, stainless steel 316
		+B	Bronze impeller; stainless steel 316 shaft
		+BII	Bronze impeller/wear plate, stainless steel 316 shaft
		+KI	Stainless steel 316 impeller and shaft
		+KII	Stainless steel impeller, wear plate and shaft
Gaskets			
N	NBR: Perbunan	+M	Cutting blade
V	FPM: Viton	+P	Perma grease cartridge
E	EPDM	+VP	Grease glass for seal lubrication
T	PTFE: Teflon	+KF	Wheelbarrow frame
K	FFKM, Kalrez	60Hz	Motor 440V – 60Hz

Contact us for more optional features.

B Series

Electrically Driven Pumps, 2-pole

Models from DN40 (1,5") to DN100 (4"). The pumps have been designed for speeds of 1500 to 3600 rpm and are driven by a two-pole electric motor. The specific feature of these models is their small size in combination with a large free passage.



Model	Pump			Connection		Motor 400V 50Hz		Assembly
	Flow m³/h	Head mwc	ø mm	mm	inch	Power kW	Speed rpm	
B40	21	15	18	40	1,5"	1,5	2850	BVGMC
B45	22	29	14	40	1,5"	2,2	2850	BVGMC
B50	35	18	25	50	2"	2,2	2850	BVGMC
B58	52	62	25	80	3"	11	2950	BVGMC
B70	82	20	22	80	3"	4	2900	BVGMC
B70-4	90	19	30	80	3"	5,5	2880	BVGMC
B85-S2	76	44	15	80	3"	11	2930	BVGMC
B85-S3	86	57	18	80	3"	18,5	2930	BVGSMC
B100-S2	120	62	29	100	4"	30	2950	BVGSMC

Contact us for the technical data of the 60 Hz models.



Electrically Driven High Head Pumps, 2-pole

Models from DN40 (1,5") to DN80 (3"). The pumps differ from the other models in the B series in higher pressure ratings. These models find applications in jetting, pressure boosting and wash plants. The pump inlet is located at the drive end side, this results in a reduced load on the drive end.



Model	Pump			Connection		Motor 400V 50Hz		Assembly
	Flow m³/h	Head mwc	ø mm	mm	inch	Power kW	Speed rpm	
B30-180	32	39	12	50 - 40	2" - 1,5"	4	2900	BVGMC
B60-180	45	35	18,5	50	2"	5,5	2880	BVGMC
B60-220	45	53	14	50	2"	11	2930	BVGMC
B70-250	70	74	12	80	3"	22	2940	BVGSMC

Contact us for the technical data of the 60 Hz models.



B Series

Electrically Driven Solids Handling Pumps, 4-pole

Models from DN80 (3") to DN250 (10"). The pumps are designed for speeds from 1000 to 2000 rpm. The pump casings are thick-walled, especially in those areas that are subject to wear during pumping of abrasive liquids. Their rugged construction makes them suitable for use under difficult conditions, for continuous operation, for abrasive and aggressive fluids.

Model	Pump				Motor 400V 50Hz		Assembly	
	Flow m³/h	Head m	ø mm	Connection				
				mm	inch			
B85	90	16	40	80	3"	5,5	1450	BVGMC
B100	140	18	46	100	4"	7,5	1460	BVGMC
B150	300	32	40	150	6"	30	1470	NMC
BE160	300	17	80	150	6"	15	1460	NMC
BE200	480	24	80	200	8"	30	1475	NMC
BE250	600	21	80	250	10"	37	1475	NMC



Diesel Driven Pumps on Wheelbarrow

B series pumps fixed to wheeled frames extends further the ease of use of the mobile pumping sets. The single-cylinder driven jetting and dewatering pumps are the most popular. They are used around the world in the most diverse range of applications.



B60 - 220 Hatz 1D90

Pump				Diesel engine				Assembly	Stock model
Model	Flow m³/h	Head m	ø mm	Brand	Model	Power kW	Speed rpm		
B30-180	32	37	12	Hatz	1B40 h.s.	7	3000	Wheelbarrow	<input checked="" type="checkbox"/>
B60-220	45	53	14	Hatz	1D90Z e.s.	11	3000	Wheelbarrow	<input checked="" type="checkbox"/>
B70-250	70	74	12	Hatz	2M41	24	3000	Wheelbarrow	<input checked="" type="checkbox"/>
B85	90	16	40	Hatz	1D81Z h.s.	5,5	1500	Wheelbarrow	<input checked="" type="checkbox"/>



B Series

BE Series Open Diesel

The wet self-priming pump casing of the B series is combined with the back pull-out of the BA series with its unique E-style impeller. This combination of a large free passage, high efficiency and excellent NPSH values results in an outstanding pump set.



BE160 site trailer

Pump				Diesel engine				Assembly	Stock model
Model	Flow m³/h	Head m	ø mm	Brand	Model	Power kW	Speed rpm		
BE160 D254	345	27	80	Perkins	404D-22	26	1800	BF10-23	☑

Tractor Driven Flood Control Pump: B300

The B300 T3WGT is an application designed flood control pump concept. The design allows a direct PTO tractor drive without any additional transmission. Self-priming, simple and reliable. With a maximum flow capacity of 1200 m³/h and solids handling of 70 mm. Ready for any emergency job! A must have pump for municipalities and governmental agencies.



Model	Pump					Motor 400V 50Hz		Assembly
	Connection		Flow m³/h	Head m	ø mm	Power kW	Speed rpm	
	mm	inch						
B300	300	12"	1200	14	70	55	960	T3WGT

